

S Stand, Cat. No. 31-27-14

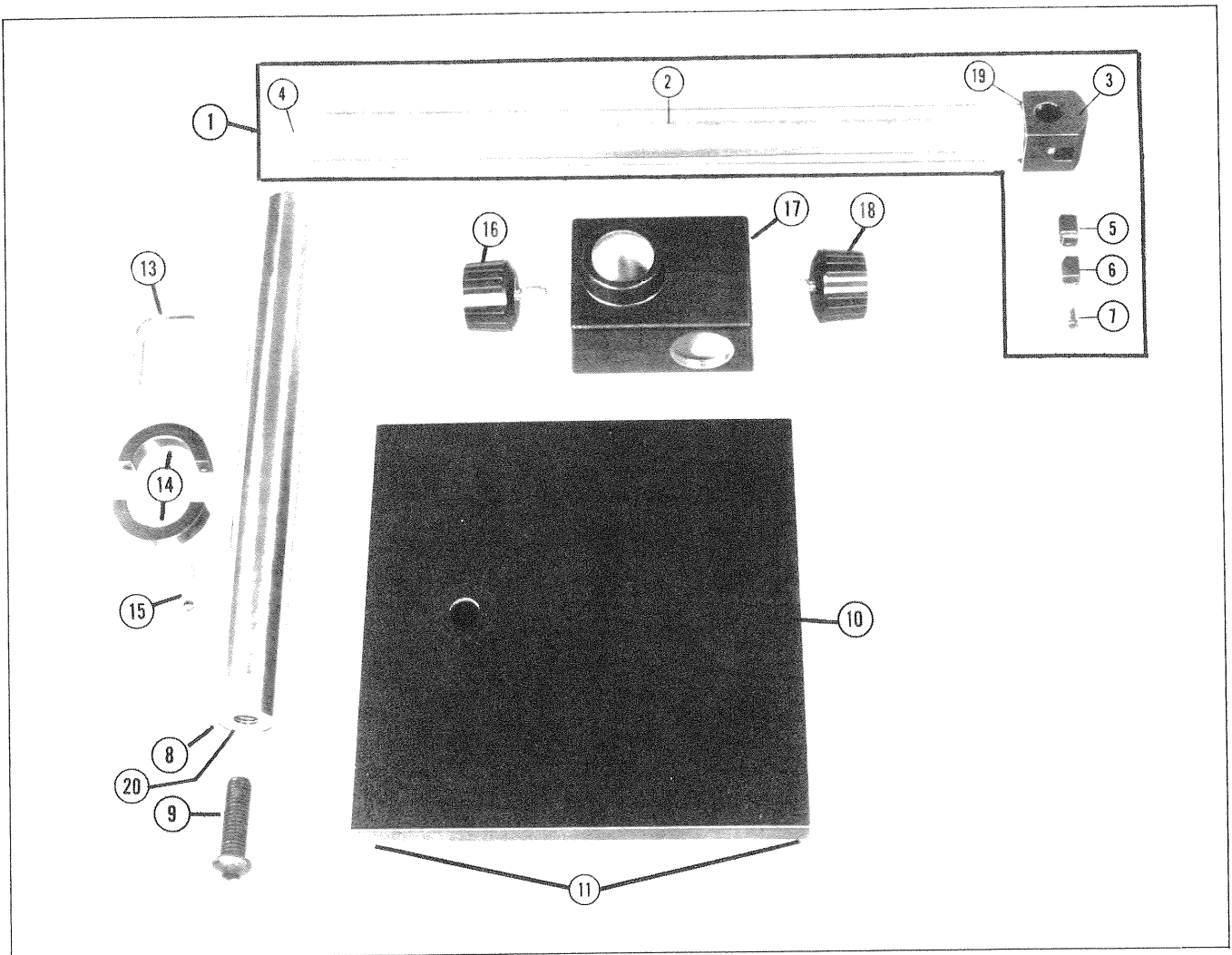

Key	Description	Part No.
1	Shaft Assembly (included parts 2 thru 7)	312714-910ND
2	Shaft	312714-121
3	Head	312714-128
4	Bottom Plug	312714-138ND
5	Clamp Shoe A	312714-126
6	Clamp Shoe B	312714-127
7	Screw	312714-141ND
8	Vertical Column	312714-122
9	Screw	312714-136ND
10	Base	312714-120
11	Feet (4 required)	312714-133ND
13	Lock Screw	312714-125
14	Collar (2 required)	312714-124
15	Screw	312714-134ND
16	Knob-Stud Assy "B"	312714-132
17	Holder	312714-113
18	Knob-Stud Assy "A"	312714-149

SK Stand, Cat. No. 31-26-97

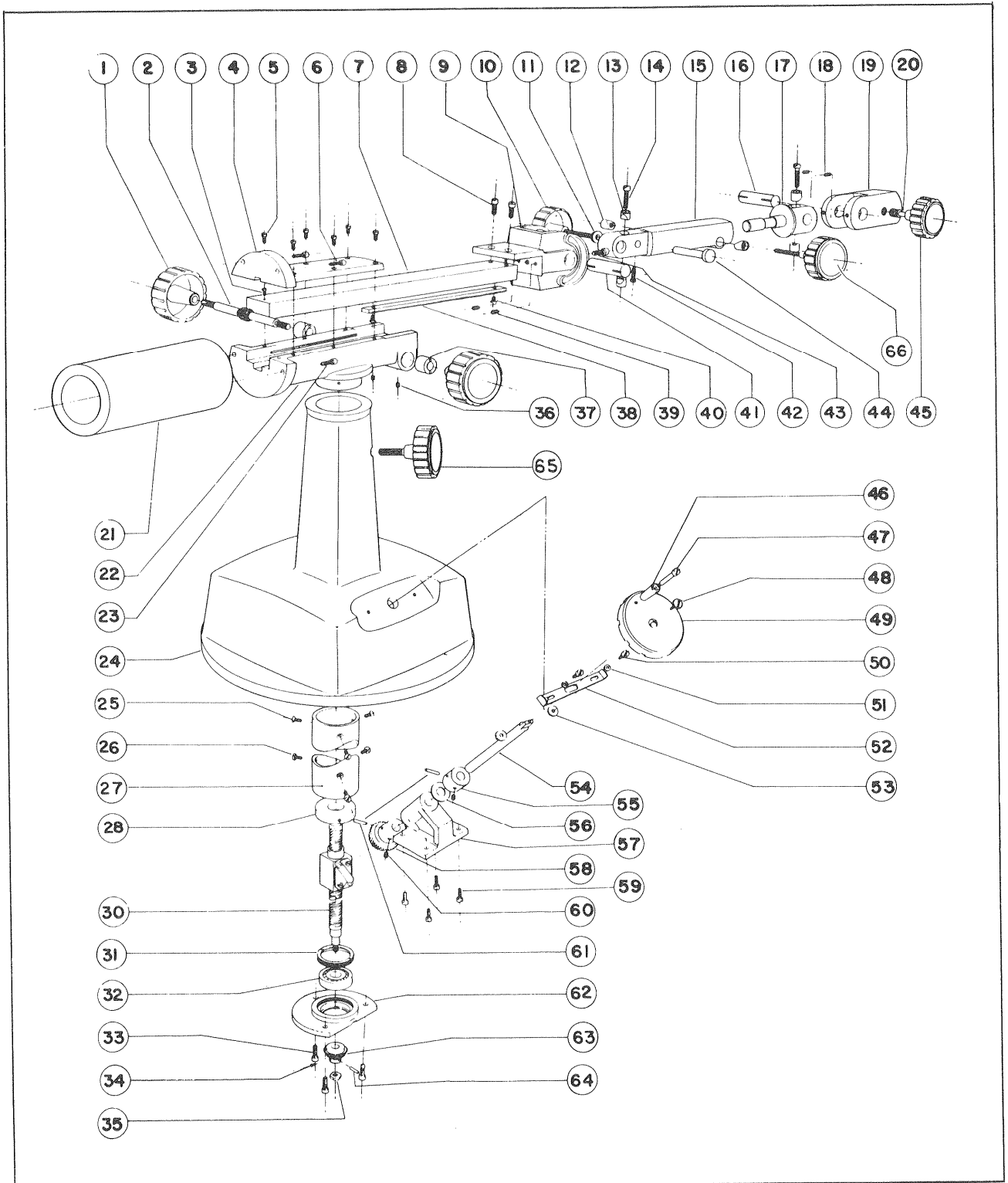

Key	Description	Part No.	Key	Description	Part No.
1	Knob Assy	312697-198	*35	10-32 Hex. Nut	716180-4600
2	Pinion	312697-193	36	10-32 x 1/8 lg Set Screw	312697-151ND
3	6-40F6T Screw	97206-1610	37	Pinion Bearing (2)	312697-132
4	Pivot Assy (Top)	312697-168	38	Arm Rack	312697-164
5	6-32 x 5/16 lg Screw (6)	316012-150	39	10-32 x 3/8 lg Set Screw (2)	312697-156ND
6	10-32 x 1/2 lg Cap Screw	312697-202ND	40	SE-43 Screw	90048-77
7	Horizontal Arm	312697-165	41	Axle "B"	312697-191
8	250-28 x 5/8 lg Cap Screw	312697-203ND	42	Screw	312697-172
9	Clamp Bearing	312697-192	43	1/4-28 x 5/8 Cap Screw	312697-203ND
10	Small Knob	312697-199	44	Clamp Pin	312697-126
	Knob Shaft	312697-196	45	Small Knob	312697-199
11	Washer	312697-140	46	Handle	312697-113
12	Clamp Shoe "B"	312690-144	47	Handle Screw	312697-114
13	Clamp Shoe "A"	312690-143	48	Knob Screw "A"	312697-116
14	10-32 x 3/4 lg Screw	312697-200ND	49	Elevation Crank	312697-112
15	Swing Arm	312697-175	50	Shoulder Screw	312697-138
16	Axle A	312697-190	51	F-261 Washer	90008-293
17	Joint B	312697-130	52	Lock Assy	312697-139
18	10-32 x 3/8 lg Screw (2)	312697-156ND	53	F-157 Washer	90008-162
19	Joint A	312697-189	*54	Drive Gear Shaft	312697-115
20	Knob Screw	312697-197	*55	Collar	312697-105
21	Counter Balance	312697-170	*56	F-239 Washer	9008-246
22	Pivot Assy (Base)	312697-168	*57	Drive Gear Bearing	312697-106
23	10-32 x 1/2 lg Cap Screw	312697-202ND	*58	Drive Gear	312697-107
24	Base	312697-206	*59	10-24F16S	96206-1002
25	10-32C12S Screw (4)	96202-2004	*60	8-36V8S Set Screw	96228-1801
26	Screw (3)	312697-167	61	I-341 Roll Pin	90011-359
27	Lift Tube	312697-103	*62	Bearing Support	312697-109
*28	Ball Nut Retainer	312697-110	*63	Driven Gear	312697-108
*30	Jack Screw & Nut	312697-101	*64	I-395 Roll Pin	90011-403
*31	Bearing Retainer	312697-111	65	Knob Assy	312697-143
*32	Ball Bearing	312697-104ND	66	Small Knob Assy	312697-199
*33	1/4-20 x 3/4 lg Cap Screw (3)	211043-204ND	* Sold in Assembled Units Only		
*34	4-48 V4M Screw	94228-1400			